

'Our country kitchen is timeless'

Inspired by their rural location, Emma and Phil Goodman-Horne created a traditional kitchen with a colourful twist

For where to buy items shown, turn the page



BEFORE



Accent colour
The couple chose the floral blinds and the green slate flooring to echo the teal tiles in the chimney breast

Emma and Phil Goodman-Horne's pretty Victorian house has one of the most idyllic settings you could hope for, set back off a country lane and surrounded by fields. But the kitchen was small, dark and dated, with an impractical layout for a family. 'We wanted a much bigger space, opening into a dining room at one end and a sitting room at the other, with no doors in between,' says Emma.

Local company Surrey Furniture designed the new kitchen and also co-ordinated the work, which came in handy when it turned out that the builders were due to start work the day Emma gave birth to her daughter, Freya, now two. 'I arrived home with my new baby and found the house full of builders,' says Emma. 'Fortunately, they rigged us up a make-do kitchen, and we pretty much lived in it.'

The open-plan space means Emma can join in the conversation with her guests while she is busy in the kitchen. 'We entertain a lot and now I don't have to be isolated from everyone,' she says. 'I love having people milling around me on both sides.'

Love their STYLE?

EMMA'S FLOORING IS FROM SILVERLAND STONE £££. FOR SIMILAR, TRY INDIAN GREEN TILES, WALLS AND FLOORS £ OR SLATE TILES IN OCEAN, ROMAN STONE ££

Open chimney
The overmantel with false open chimney breast was Emma and Phil's idea. 'We wanted to create a focal point in the room, and I think it works very well because it's so striking,' says Emma



Take the 60-second tour

THE PROPERTY

A four-bed semi-detached cottage in Send, Surrey.

WHAT IT COST

Units.....£7,000
Worktop.....£3,500
Sink & tap.....£639
Floor.....£2,500
Appliances.....£3,000
TOTAL.....£16,639

WHO LIVES HERE

Emma Goodman-Horne, her

husband Phil, and their children, Harrison, 12, and Freya, two.

WHAT THEY DID

Extended at the back and demolished interior walls to create an open-plan living space designed by local company Surrey Furniture.

THE LOOK

A country kitchen with traditional hand-crafted,

painted wood units, slate flooring, granite worktops and curved corner cupboards.

LESSONS LEARNED

'Careful planning is the key to success, and make sure you do plenty of research to get what you want at the best prices. We were looking for good deals on several things – worktop, flooring, accessories, appliances – right up to the last minute.'

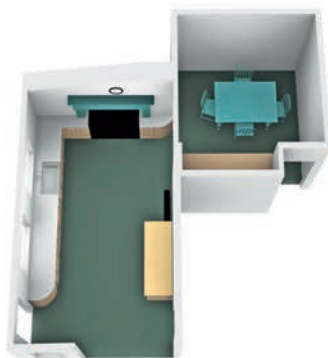

THE LAYOUT The kitchen opens into a living room at one end and a dining area, including the fridge and extra cupboards, at the other

Turn over to see how the Goodman-Hornes created their new kitchen

We love... BESPOKE COUNTRY



Clever cupboards
Despite the lack of wall units, there is plenty of cleverly designed storage space, including slim pull-out drawers next to the hob

IDEA The curved units are used to store the children's crockery and Freya's baby food. 'They are practical, with no sharp corners to hurt Freya,' says Emma



Stacks of storage
The fridge-freezer is housed in the dining area, along with extra built-in storage. 'I am a bit of a storage freak,' admits Emma. 'I like having a place for everything'

WHERE TO BUY
ITEMS SHOWN

Neptune Chichester units, from £345 for a 350mm base unit, and sideboard, £1,075; granite worktop, £325 per sq m; Villeroy & Boch Farmhouse 80 sink, £399; Perrin & Rowe 4460CP tap, £240; dining table, £630; blackboard, £45; all Surrey Furniture. Floor tiles, £43.86 per sq m, Silverland Stone. Samsung fridge-freezer, £900; Rangemaster Elan 110 cooker, £1,600; both Boots. Walls painted in Quartz Stone matt emulsion, £29.50 for 2.5ltr, Fired Earth. Mantel, unit knobs and dining table painted in Herringbone matt emulsion, £20.99 for 2.5ltr, Crown Paints. For similar dining chairs, try the Farmhouse Slat Back, from £60 each, Whitstable Interiors. For similar blind fabric, try Notting Hill in Duck Egg Blue, £10.99 per m, Fabricaz. For similar wall tiles, try Metro Glass in Teal, from £5.99 per tile, Topps Tiles. For a similar door, try the Stable Cottage door, £264, Kershaws Door Warehouse; painted in Ultramarine Ashes matt emulsion, £29.50 per 2.5ltr, Fired Earth. Clock, £50, The Packhouse

For stockist details, turn to page 208

FEATURE SHARON SMITH PHOTOGRAPHS DAVID GILES PLAN PERSONA-ID



Character door
A stable door, painted to complement the mantel and dining table, continues the country theme



How we did it

“ We wanted a traditional-style kitchen to suit the age of the house.

We opted for neutral units and worktops to keep it as light as possible, and built a false chimney to make a feature of the cooker, then used teal, which is my favourite colour, for the tiles behind the hob and in the window blinds. We picked a slate floor because, with young children and plenty of guests, it is hard wearing and easy to clean. The work took six months and cost around £30,000, because we built an extension at the back, plus we had to knock down walls to open up the rooms. ”